

Autodesk User Conference 2016 Powered by cadline



Technical Masterclass : Autodesk Showcase

Presented by : Stuart Tanfield



www.cadline.co.uk



www.cadlinecommunity.co.uk

 **AUTODESK.**
Platinum Partner
Consulting Specialized

Presentation Agenda

- Welcome
- What is Showcase
- Linking with Revit
- Apply Materials
- Create Cross Sections
- Linking to Behaviors
- Creating Animation
- Stitching together the storyboard
- Publish Movie and images
- Other features discussion
- Q&A



Technical Deliverables

- Autodesk Showcase Masterclass – Guidance notes
- This presentation
- [Click for Cadline Community Showcase mini-site](#)

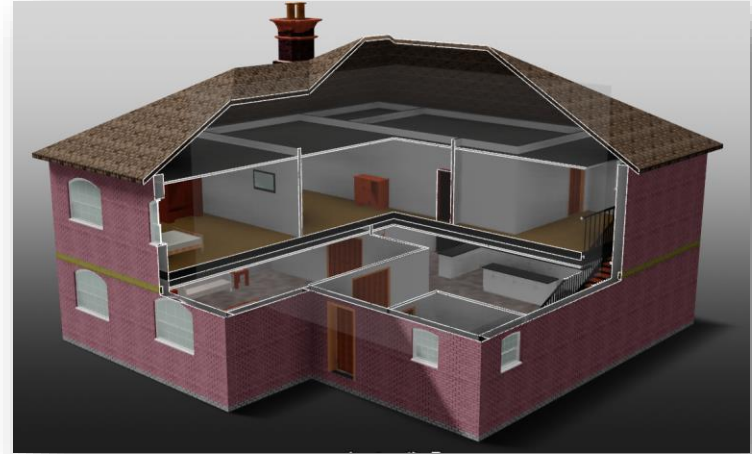

Call to Action



- 👉 Book a FREE Technical Discovery meeting
- 👉 Speak to your Account Manager
- 👉 Complete the request form in your packs

Book your FREE Business Discovery Meeting

Book a free Business Discovery Meeting to see how the team can help you by calling us on **01784 419922** or **complete a brief online form**.



A pocket watch with a white face, Roman numerals, and a moon phase sub-dial. The watch is set against a background that transitions from red at the bottom to orange at the top. A semi-transparent purple horizontal band is overlaid across the middle of the watch face.

Thank you for your time